

FrameriTreadTM
AMERICA'S FAVORITE

PATENT PENDING

Installation Guide

(for Straight Treads)



3382020
Scan for Video
Instructions



Framerica[®]
AMERICA'S FAVORITE

Yaphank, NY • Framerica.com

© Copyright 2020. Framerica Corporation. All rights reserved.

Framerica is a registered trademark of Framerica Corporation. FrameriTread, NoseFill, and FrameriCap are trademarks of Framerica Corporation.

Tools Recommended



measuring tape



scraper



miter saw



table saw or circular saw



snips or cutting pliers



mallet



urethane based construction adhesive



caulk gun

fig. 1

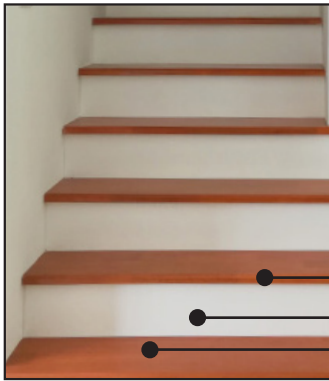

The Anatomy of a Step

FAMILIARIZE YOURSELF WITH THE ANATOMY OF A STEP.
 (FIG. 1)

Bullnose

Riser

Tread

DO NOT PROCEED WITH INSTALLATION UNTIL THESE INSTALLATION GUIDELINES HAVE BEEN COMPLETELY REVIEWED

Preparing for your project

1. Start by removing any carpet, pad, tackstrip, staples or glue from your stairs.
2. Remove spindles from your staircase prior to installing FrameriTread™ products.
(Tip: number the spindles and create a template / record of existing spindle recesses / holes)
3. Ensure your workspace is free of dirt and debris prior to installation.

4. FrameriTread™ requires a bullnose on existing stair treads. Most existing treads have a bullnose. If so, skip to: **Installing your FrameriTread™**. If your existing tread does not have a bullnose, continue to: **Installing Your NoseFill™**

BULLNOSE

If your staircase has an existing bullnose:
 Proceed to **Installing your FrameriTread™**.

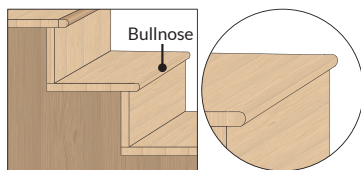

NO BULLNOSE?

If your staircase does not have an existing bullnose:
 Proceed to: **Installing your NoseFill™**.

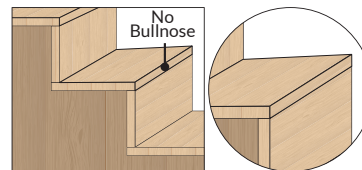

Cutting your Nosefill™

1

Measure the length of the existing stair tread and draw a pencil line at the measured length on the NoseFill™. Cut NoseFill™ at measured length.

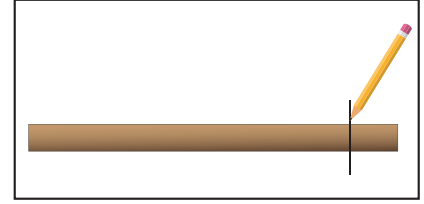
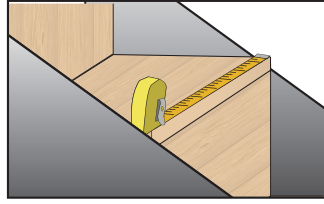

2

Using urethane based construction adhesive, apply a ¼ inch bead down the length of the flat side of your NoseFill™.

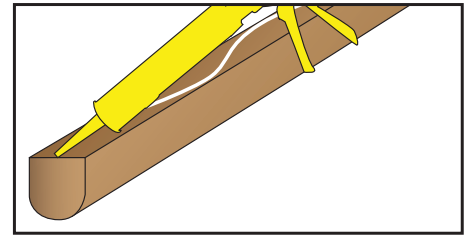

3

Nail the NoseFill™ on the front face of your tread.

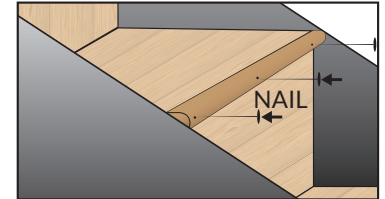
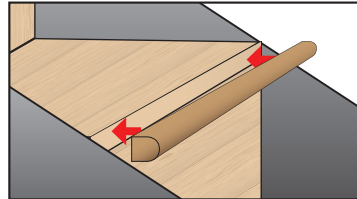

4

Remove any excess adhesive immediately.

Allow sufficient adhesive dry time before proceeding to: **Installing your FrameriTread™**

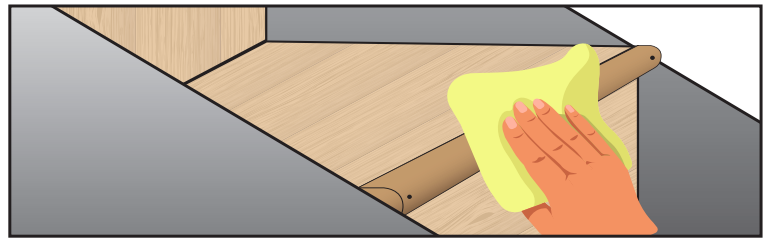

Installing your FrameriTread™

Cutting your FrameriTread™

5

Starting at the bottom step, measure the length and depth of your step using a tape measure. (*or a Lumber Liquidator's tread tool)

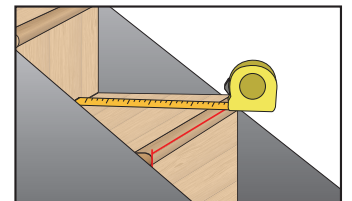
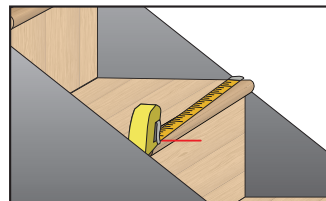

6

Draw a line at the measured depth and length (A,B) on your FrameriTread™ and cut to size.



Installing your FrameriTread™

7

Using urethane based construction adhesive such as Bostik Tread-lock® or Bostik's Best®, apply a 1/4" bead around the perimeter of the step and then throughout the middle in a serpentine pattern, as shown.

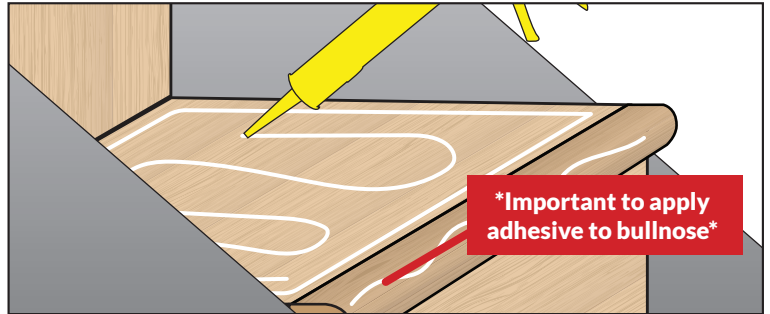

8

Carefully position FrameriTread™ on step and slide into place.

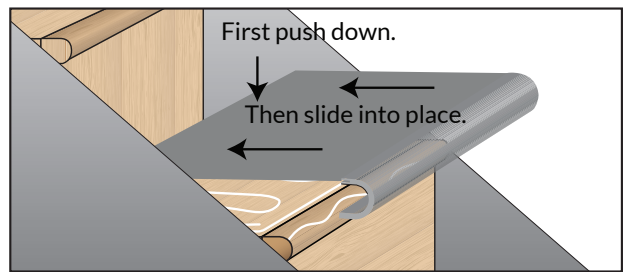

9

REMOVE ANY EXCESS ADHESIVE IMMEDIATELY.

DO NOT USE STEPS UNTIL ADHESIVE IS FULLY CURED!

10

REPEAT THE PROCESS FOR EACH STEP.

WARNING TO CALIFORNIA RESIDENTS

This product may be a wood based product, and wood dust may be generated while cutting, sawing, sanding, machining or otherwise altering this product. Wood dust has been classified by the state of California (OEHHA PROP 65) as a substance known to cause cancer.

This product is CARB Phase 2 93120/EPA TSCA Title VI compliant for formaldehyde.

It is recommended that respiratory protection be used when engaging in activities with respect to this product which may result in exposure to wood dust.